

PERMEABLE AREAS:		
LOT	SITE AREA	PERMEABLE SURFACES
1	175M <sup>2</sup>	51M <sup>2</sup> (29.14%)
2	175M <sup>2</sup>	46.6M <sup>2</sup> (26.62%)
3	138M <sup>2</sup>	31.2M <sup>2</sup> (22.60%)
4	147M <sup>2</sup>	51.2M <sup>2</sup> (34.83%)
5	149M <sup>2</sup>	45.5M <sup>2</sup> (30.54%)
6	139M <sup>2</sup>	25M <sup>2</sup> (17.98%)
SITE	1,024M <sup>2</sup>	250.5M <sup>2</sup> (24.46%)

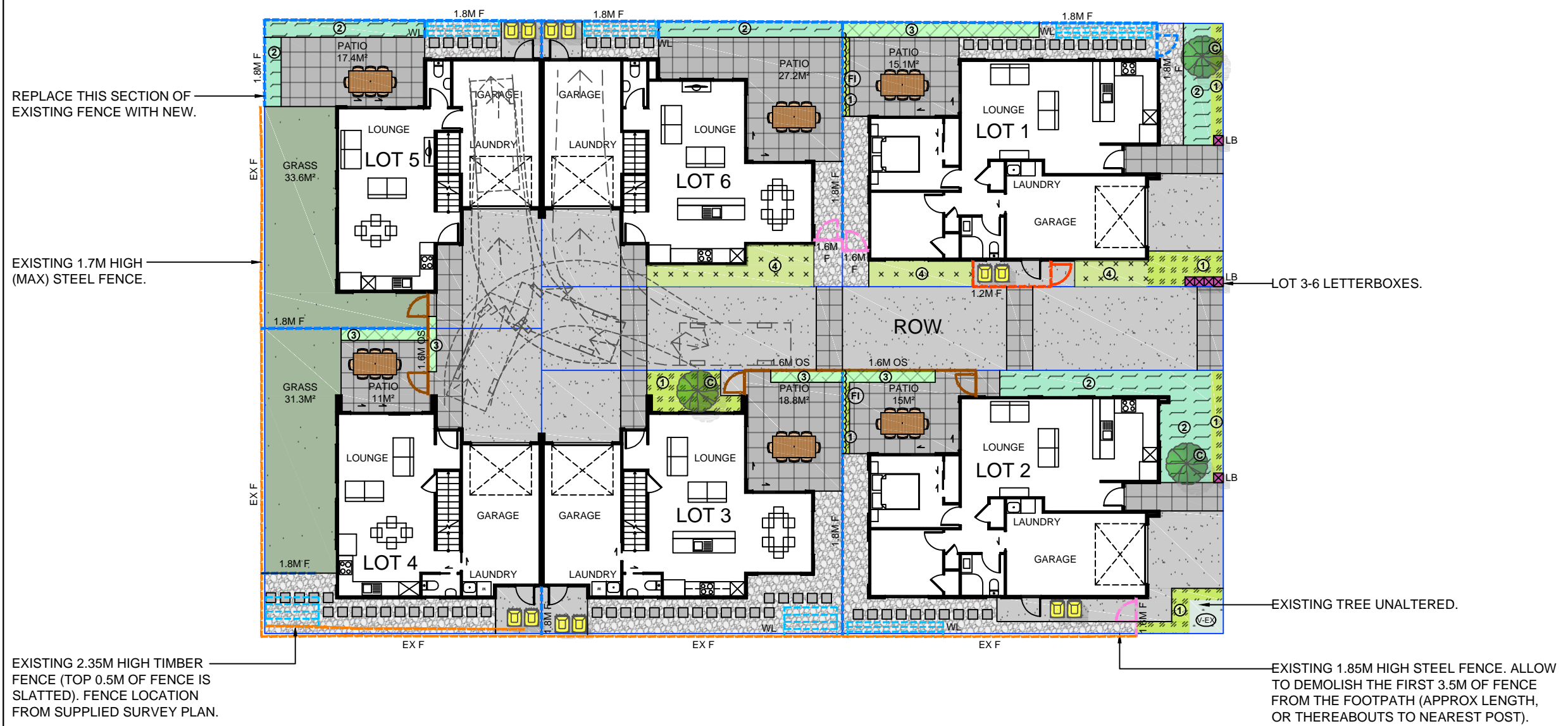
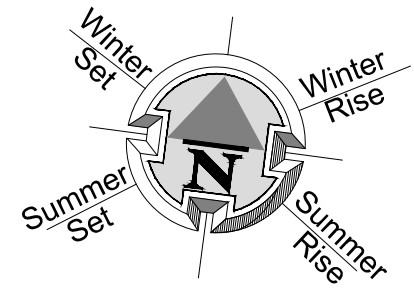

LEGEND	
	GRASS OR ARTIFICIAL GRASS (PERMEABLE)
	CONCRETE. BRUSH FINISH OR ASPHALT.
	STONES (PERMEABLE).
	STONES WITH PAVERS
	PAVING, EXPOSED AGGREGATE FINISH CONCRETE, COLOURED CONCRETE OR CONCRETE WITH DECORATIVE SAWCUTS.
	1.8M F 1.8M HIGH ROUGH SAWN CLOSED BOARDED TIMBER OR METAL PANEL FENCE.
	1.6M OS 1.6M HIGH HORIZONTAL OPEN SLAT FENCE (TIMBER OR METAL - TBC BY CLIENT).
	1.6M F 1.6M HIGH ROUGH SAWN CLOSED BOARDED TIMBER OR METAL PANEL FENCE.
	1.2M F 1.2M HIGH ROUGH SAWN CLOSED BOARDED TIMBER OR METAL PANEL FENCE.
	EX F EXISTING FENCE UNALTERED. REFER NOTES FOR DETAILS.
	SERVICE AREA FOR BINS
	LETTERBOX. MAIL SLOT 900MM - 1200MM FROM THE GROUND
	WL WASHING LINE

REFER PRIME DESIGN'S PLANS FOR MINOR EARTHWORKS.

**AFFIX HOUSE NUMBER TO EACH DWELLING.**

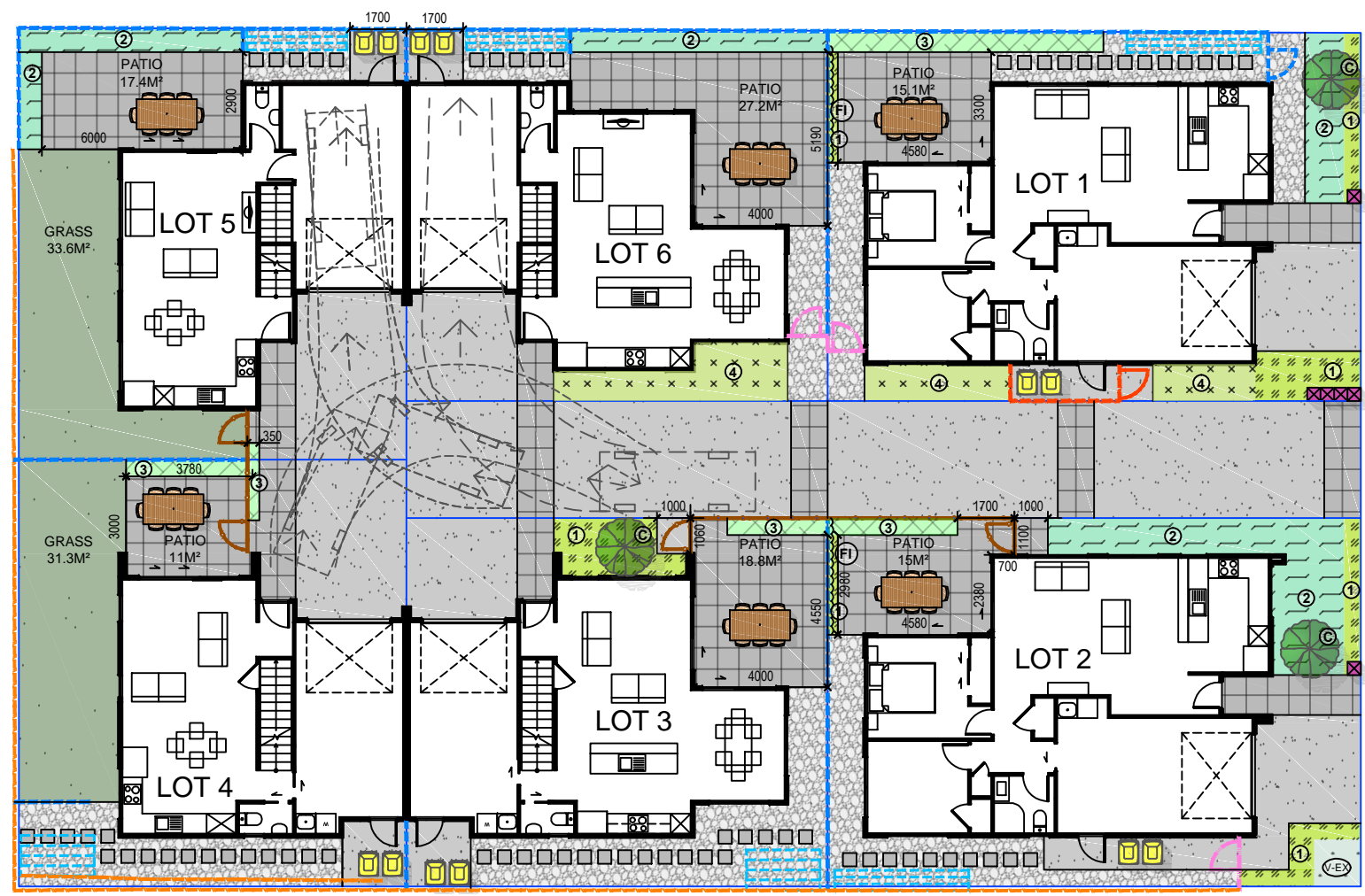
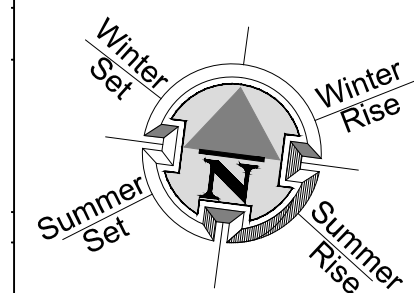



LEGEND	
	GRASS OR ARTIFICIAL GRASS (PERMEABLE)
	CONCRETE. BRUSH FINISH OR ASPHALT.
	STONES (PERMEABLE).
	STONES WITH PAVERS
	PAVING, EXPOSED AGGREGATE FINISH CONCRETE, COLOURED CONCRETE OR CONCRETE WITH DECORATIVE SAWCUTS.
	1.8M F 1.8M HIGH ROUGH SAWN CLOSED BOARDED TIMBER OR METAL PANEL FENCE.
	1.6M OS 1.6M HIGH HORIZONTAL OPEN SLAT FENCE (TIMBER OR METAL- TBC BY CLIENT).
	1.6M F 1.6M HIGH ROUGH SAWN CLOSED BOARDED TIMBER OR METAL PANEL FENCE.
	1.2M F 1.2M HIGH ROUGH SAWN CLOSED BOARDED TIMBER OR METAL PANEL FENCE.
	EX F EXISTING FENCE UNALTERED. REFER NOTES FOR DETAILS.
	SERVICE AREA FOR BINS
	LB LETTERBOX. MAIL SLOT 900MM – 1200MM FROM THE GROUND
	WL WASHING LINE



REFER PRIME DESIGN'S PLANS FOR MINOR EARTHWORKS.

**AFFIX HOUSE NUMBER TO EACH DWELLING.**







TYPE C CITRUS PLANT SELECTION OPTIONS:





KEY	DESCRIPTION	LEMON - MEYER OR LISON SEEDLESS DWARF	LIME - BEARRS DWARF OR KAFFIR DWARF
	WIDTH X HEIGHT	1.5X2M	1X1.5M
	PLANT ATTRIBUTES: - CITRUS FRUIT - SELECT 2L MINIMUM POT SIZE		

KEY	DESCRIPTION	IMAGE	PLANT SPECIES	SPACING	MATURE SIZE
	PLANT ATTRIBUTES: - EVERGREEN - CLIMBING - SELECT 2L MINIMUM POT SIZE		FICUS PUMILA - CLIMBING FICUS	0.8M	3M + (CLIMBER)



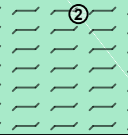
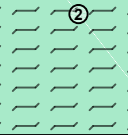

TYPE 1 NATIVE GROUND COVER/ SPREADING SELECTION OPTIONS:

KEY	DESCRIPTION	LIBERTIA (NZ IRIS) - IXIODES - PEREGRINANS OR SIMILAR	PIMELEA PROSTRATA - NZ DAPHNE	PRATIA ANGULATA - PANAKENAKE
	WIDTH X HEIGHT	0.4M HIGH + SPREAD	1X0.1M	1X0.2M
	SPACING	4/SQM	4/SQM	4/SQM
	PLANT ATTRIBUTES: - FLOWERING - NZ NATIVES - EVERGREEN - NO MINIMUM POT SIZE			





TYPE 2 NATIVE SHRUB SELECTION OPTIONS:

KEY	DESCRIPTION	PITTOSPORUM - GOLF BALL OR - MIDGET	HEBE - CONTRACTOR TO SELECT GENUS FOR 1M MAX MATURE HEIGHT	ASTELIA - WESTLAND OR RED DEVIL OR SIMILAR
	WIDTH X HEIGHT	1X1M	0.75X0.75M	1X1M
	SPACING	2/SQM	2/SQM	2/SQM
	PLANT ATTRIBUTES: - NZ NATIVES - EVERGREEN - NO MINIMUM POT SIZE - PLANT SPECIES IN CLUSTERS OF 5-11 MIN			

TYPE 3 NATIVE SHRUB SELECTION OPTIONS:

KEY	DESCRIPTION	ANEMANTHELE LESSONIANA 'WIND GRASS'	APODASMIA SIMILIS 'OIOI'	PHORMIUM - GREEN DWARF OR PEPE OR SIMILAR DWARF FLAX
	WIDTHXHEIGHT	0.75X1M	1X1M	0.75X0.75M
	SPACING	2/SQM	2/SQM	2/SQM
	PLANT ATTRIBUTES: - EVERGREEN - NZ NATIVES - NO MINIMUM POT SIZE - PLANT SPECIES IN CLUSTERS OF 5-11 MIN			

TYPE 4 NATIVE SHRUB SELECTION OPTIONS:

KEY	DESCRIPTION	ARTHROPODIUM 'RENGA RENGALILY'	ASPENIUM OBLONGIFOLIUM - SHINING SPLEENWORT	MYOSOTIDIUM HORTENSIA CHATHAM ISLAND FORGET ME NOT
	WIDTHXHEIGHT	0.5X0.5M	0.8X1M	0.5X0.5M
	SPACING	4/SQM	2/SQM	4/SQM
	PLANT ATTRIBUTES: - EVERGREEN - NZ NATIVES - NO MINIMUM POT SIZE - PLANT SPECIES IN CLUSTERS OF 5-11 MIN			

**NOTES:**  
- SPACE PLANTS EVENLY.  
- PLANT IMAGES INDICATIVE ONLY.  
- GROWTH AND MATURE SIZE INFORMATION ARE GIVEN IN GOOD FAITH BUT ARE SUBJECT TO NATURAL VARIABLES BEYOND OUR CONTROL.  
- EXPERIENCED LANDSCAPER TO PLACE ALL PLANTS AND SELECT THE GENUS (WHERE NOT SPECIFICALLY NOTED) OF ALL PLANTS APPROPRIATE FOR THE SPECIFIC SITE CONDITIONS.

**LANDSCAPING SPECIFICATION:**

**DISCLAIMER:** DRAWINGS AND SPECIFICATIONS HAVE BEEN PREPARED ON THE UNDERSTANDING THAT THE BUILDING CONTRACTOR(S) HAS SOUND KNOWLEDGE AND EXPERIENCE FOR THE SCOPE OF WORKS. WORKMANSHIP AND MATERIALS SHALL BE IN ACCORDANCE WITH RELEVANT AND LATEST CODES, TECHNIQUES AND SUPPLIER REQUIREMENTS.

- READ IN CONJUNCTION WITH THE SUBDIVISION AND ARCHITECTURAL DRAWINGS.
- FLOOR PLANS AND SITE PLANS INCLUDING BOUNDARIES AND VEHICULAR TRACKING CURVES, FROM ARCHITECT/ SURVEYOR. WE DO NOT TAKE LIABILITY FOR ITS ACCURACY. VERIFY SITE FEATURES ON SITE BEFORE CONSTRUCTION COMMENCES.
- REFER ARCHITECTURAL PLANS FOR SITE DRAINAGE.
- ENSURE GARDENS ARE 225MM MIN BELOW FINISHED FLOOR LEVEL. ENSURE PERMANENT PAVING 175MM MIN BELOW FINISHED FLOOR LEVEL.
- LANDSCAPE PLAN IS INDICATIVE. ALLOW TO CONFIRM LANDSCAPE POST BUILDING CONSTRUCTION.
- DO NOT SCALE OFF DRAWINGS. REFER TO FIGURED DIMENSIONS ONLY.
- RETAINING WALLS AND BATTER BANKS ARE INDICATIVE ONLY AND ARE SUBJECT TO CHANGE. REFER ENGINEER'S DOCUMENTATION FOR DETAILS.

**MYRTLE FAMILY:** CONTRACTOR TO FOLLOW PROTOCOLS AND PRECAUTIONS OF NZ PLANT PRODUCERS INC. (NZPPI) FOR PLANTS IN THE MYRTLE FAMILY (FAMILY MYRTACEAE). IMMEDIATELY REPORT ANY SUSPECTED MYRTLE RUST TO THE PROPERTY OWNER AND MINISTRY FOR PRIMARY INDUSTRIES (MPI).

**GENERAL NOTES:**

- PLANTING OPERATIONS SHALL BE CARRIED OUT DURING THE PERIOD FROM 1 APRIL TO 30 SEPTEMBER.
- PLANT TREES, PLANTS AND SHRUBS AS SOON AS POSSIBLE AND NO LATER THAN 3 DAYS AFTER DELIVERY, KEEPING THE ROOTBALL MOIST.
- ENSURE THAT ALL AREAS ARE CLEAN, READY TO BE WORKED AND CLEAR OF ANY CONTINUING WORK BY OTHERS.
- CHECK FOR SERVICES IN THE AREA OF THIS WORK. AVOID INTERFERENCE OR DAMAGE TO THEM.
- ALL PROPOSED FINISHED LANDSCAPING LEVELS TO CONFORM TO NZS 3604, SECTION 6.14, PREVENTION OF DAMPNES AND SECTION 7.5.2, FINISHED FLOOR LEVELS AND FOUNDATION EDGE CONSTRUCTION, IN RELATION TO ANY ADJOINING HABITABLE FLOOR LEVELS. MAINTAIN THE REQUIRED COVER OVER ANY BURIED SERVICES.
- CONFIRM LOCATION OF ANY UNDERGROUND SERVICES & CABLING PRIOR TO ANY DIGGING.
- TREES PLANTED NEAR DRAINS SHOULD BE REPLACED PERIODICALLY DEPENDING ON THE TREE GROWTH RATE. FAST GROWING TREES SHOULD BE REPLACED EVERY 10 YEARS.
- ON COMPLETION ALLOW TO CLEAN UP AROUND AROUND THE AREA OF WORKS. REMOVE ALL SURPLUS SOIL, UNUSED MATERIALS AND PLANTS, FROM THE SITE.

**PROVIDE TREES, SHRUBS AND PLANTS WHICH ARE:**

- FREE FROM PESTS AND DISEASES
- TRUE TO NAME SPECIFIED ON LANDSCAPE PLAN AND TAGGED WITH THE GROWERS' OWN TAG
- IN A MINIMUM CONTAINER SIZE AS SHOWN ON THE PLANTING SCHEDULE
- HEALTHY AND VIGOROUS, WITH WELL DEVELOPED ROOT SYSTEMS, IN BALANCE WITH THE AMOUNT OF FOLIAGE GROWTH, WELL BRANCHED AND SYMMETRICALLY SHAPED OF A NORMAL HABIT
- GROWN UNDER SOIL AND CLIMATIC CONDITIONS THAT ARE NOT SUBSTANTIALLY DIFFERENT FROM THAT OF THE CONTRACT AREA
- REJECT ALL ROOT BOUND PLANTS AND THOSE WITH SPIRALLY BOUND ROOT SYSTEMS.

ITEM	GENERAL SPECIFICATION
BACKFILLING	THOROUGHLY MIXED MEDIUM OF 30% PEAT AND 70% TOPSOIL BY VOLUME.
FERTILISER - GENERAL	PRE-PLANT, SLOW RELEASE, NON-BURNING COMPLETE NPK (NITROGEN, PHOSPHOROUS, POTASSIUM) RATIO OF 5:5.5:4.1, WITH ADDED MICRO-NUTRIENTS IRON, SULPHUR AND MAGNESIUM. ADD GYPSUM, BLOOD AND BONE AND POTASH WHERE REQUIRED BY SOIL COMPOSITION OR PLANT TYPE.
FERTILISER - GRASS SEEDING OR TURFING	PRE-PLANT, SLOW RELEASE, NON-BURNING COMPLETE NPK (NITROGEN/PHOSPHOROUS/POTASSIUM) RATIO OF 20:11:10 WITH ADDED MICRO-NUTRIENTS IRON, SULPHUR AND MAGNESIUM.
GRASS, TURFED	BLENDED LOCAL AND IMPORTED LAWN GRASSES IN SELECTED NETTED TOPSOIL, TO FINISH AS A DEEP, GREEN, WEED-FREE, UNIFORM, CLOSE DENSITY LAWN TURF IN 1.0M <sup>2</sup> ROLLS.
GRASS, SOWN	CERTIFIED MIXTURE OF GRASS SEED TO SUIT LOCAL SITE CONDITIONS, WITH A HIGH GERMINATION RATE, FUNGICIDE AND BIRD-REPELLENT TREATED. SUPPLY FOR REVIEW THE PROPOSED MIXTURE AND AREA OF USE.
HERBICIDES	POST-EMERGENCE SELECTIVE CHEMICAL TO CONTROL BROADLEAF WEEDS AND/OR A NON-SELECTIVE CHEMICAL.
MULCH	MULCH SHALL BE COARSE GRADE GRANULATED BARK WITH A PARTICLE SIZE UP TO 50MM WITH NO MORE THAN 25% SMALLER THAN 6MM, FREE FROM DISEASE, DUST, WOOD SLIVERS AND OTHER FOREIGN MATTER.
PLANT MIX	THOROUGHLY MIXED MEDIUM OF 60% COMPOST AND 40% BARK, PUMICE AND FERTILISER BY VOLUME.
STAKES	ROUGH SAWN RADIATA PINE H4 TREATED. 50X50MM, LENGTH TO SUIT TREE/ PLANT SIZE.
TOPSOIL	GOOD QUALITY LOAM OF A WORKABLE CONSISTENCY STRIPPED FROM ITS ORIGINAL LOCATION TO A MAXIMUM DEPTH OF 200MM: <ul style="list-style-type: none"> <li>• FREE OF PERNICIOUS WEEDS, STRAW, STONES, STICKS, CLAY LUMPS</li> <li>• FREE OF FOREIGN MATTER EXCEEDING 25MM DIMENSION.</li> <li>• PH VALUE BETWEEN 6.5 AND 7.5</li> <li>• HUMUS CONTENT GREATER THAN 50%.BIODEGRADABLE WEED SUPPRESSANT MATTING OR WOVEN CONSTRUCTION STABILISED POLYPROPYLENE FABRIC.</li> </ul>

**LANDSCAPING SPECIFICATION:**

**PREPARATION OF PLANTING AREAS**

REPLACE SUBSTANDARD SOIL WITH 200MM LAYER OF PLANT MIX. PLACE IN 100MM LAYERS, LIGHTLY COMPACTED BY HEELING OR ROLLING AND SLIGHTLY MOUNDED IN THE CENTRE OF THE BED.

THOROUGHLY SPRAY PLANTING AREAS WHICH CONTAIN WEED GROWTH WITH A NON-SELECTIVE HERBICIDE. APPLY USING PROTECTIVE CLOTHING, IN DRY, STILL-AIR CONDITIONS TO THE SPRAY MANUFACTURER'S REQUIREMENTS.

**PREPARATION OF GRASS AREAS**

REPLACE SUBSTANDARD SOIL WITH 150MM LAYER OF TOPSOIL. ROTARY HOE IN TWO DIRECTIONS TO A DEPTH OF 150MM AND BRING UP TO THE REQUIRED TOPSOIL STANDARD. RAKE TO A FINE TILTH, LEVEL AND SMOOTH WITH RUN-OFFS TO DRAINAGE OUTLETS. APPLY SELECTIVE HERBICIDE.

THOROUGHLY SPRAY GRASS AREAS WHICH CONTAIN WEED GROWTH WITH A NON-SELECTIVE HERBICIDE. APPLY USING PROTECTIVE CLOTHING, IN DRY, STILL-AIR CONDITIONS TO THE SPRAY MANUFACTURER'S REQUIREMENTS.

**SITING**

POSITION AND SPACE OUT TREES AND SHRUBS IN LOCATIONS AND QUANTITIES SHOWN ON THE DRAWINGS. WHERE LAYOUT IS NOT SHOWN ON THE DRAWINGS, CONFIRM LAYOUT AND SPACING WITH DESIGNER. ORGANISE PLANTING TO AVOID UNDUE COMPACTION OF PLANTING AREAS. RE-CULTIVATE ANY HEAVILY COMPACTED AREAS PRIOR TO PLANTING.

REPORT THE EXISTENCE OF ANY BURIED SERVICES OR CONCRETE FOOTINGS RESTRICTING THE ACCURATE PLACEMENT OF PLANTS TO THE CONTRACT ADMINISTRATOR FOR INSTRUCTION.

**PREPARATION FOR PLANTING LARGE TREES AND SHRUBS**

EXCAVATE PLANTING HOLES TO TWICE THE DIAMETER AND 1½ TIMES THE DEPTH OF THE ROOTBALL. WHERE DEPTH EXCEEDS THE DEPTH OF THE TOPSOIL, CARRY ON DOWN INTO SUBSOIL A FURTHER 150MM, BREAKING IT UP AND MIXING IN PEAT OR A CLAY-KILLER BEFORE REPLACING. SCARIFY THE SIDES OF HOLES IN CLAY SOILS. PROVIDE DRAINAGE BENEATH PLANTING IN IMPERVIOUS SOILS. PLACE PLANT MIX TO SUPPORT THE ROOTBALL AT A LEVEL TO ALLOW THE TOP TO FINISH FLUSH WITH SURROUNDING GROUND.

**PLANTING LARGE TREES AND SHRUBS**

DRIVE TWO PLUMB STAKES, LOCATED TO AVOID WIND-CONTACT WITH THE TREE OR SHRUB AT OPPOSITE SIDES OF THE PLANTING HOLE. KEEPING ROOTBALL INTACT PLACE EACH PLANT PLUMB WITH ITS BEST SIDE FACING INTO THE PREVAILING WIND. BACKFILL IN 150MM LAYERS USING ROD OR FINGERS TO EVENLY FIRM WITHOUT COMPACTION TO A LEVEL THAT WILL ALLOW THE TOP OF THE ROOT BALL TO FINISH FLUSH WITH SURROUNDING GROUND. WHEN COMPLETED, FIRM EACH PLANT IN BY HEELING. TIE PLANTS AT 2/3 THE HEIGHT OF THE MAIN STEM LEAVING ENOUGH PLAY FOR A SMALL AMOUNT OF NATURAL MOVEMENT. WATER IN IMMEDIATELY AFTER PLANTING TO SATURATION LEVEL IN SURROUNDING SOIL AND THOROUGHLY WET ALL FOLIAGE. SPREAD 75MM TO 100MM LAYER OF SELECTED MULCH ON WEED MAT OVER NEWLY PLANTED AREAS ENSURING IT IS NOT MOUNDED UP AROUND PLANTS AND THAT ANY DRAINAGE MATERIAL IS UNDISTURBED AND ALL BURIED SERVICES ARE UNDAMAGED.

**PREPARING FOR PLANTING SMALL AND MEDIUM SHRUBS**

PLACE PLANT MIX 200MM DEEP AND IN 100MM LAYERS, LIGHTLY COMPACTED PLANT MIX BY HEELING OR ROLLING AND SLIGHTLY MOUNDED IN THE CENTRE OF THE BED. EXCAVATE PLANTING HOLES TO TWICE THE DIAMETER AND 1½ TIMES THE DEPTH OF THE ROOTBALL.

**PLANTING SMALL AND MEDIUM SHRUBS**

KEEPING ROOTBALL INTACT, PLACE EACH PLANT PLUMB WITH THE TOP OF THE ROOTBALL AT THE TOP OF THE PLANT MIX. BACKFILL MATERIAL USING FINGERS TO EVENLY FIRM WITHOUT COMPACTION, BEFORE FINALLY FIRING THE PLANT WITH THE BASE OF THE PALM OF THE HAND. WATER IN IMMEDIATELY AFTER PLANTING TO THE SATURATION LEVEL OF SURROUNDING SOIL. SPREAD 100MM LAYER OF BARK MULCH ON WEED MAT OVER NEWLY PLANTED AREAS.

**LAYING GRASS TURF**

CULTIVATE THOROUGHLY AREA TO BE TURFED TO A DEPTH OF 100-150MM AND ROUGHLY LEVEL. CONSOLIDATE BY HEELING AND RAKE TO REQUIRED LEVELS, FINISHING 12MM BELOW KERBS AND PATHS. ADD FERTILISER, RAKING IT IN TO THE TOP 30-50MM AND BRING TO A SMOOTH, LEVEL SURFACE. LEAVE TO SETTLE FOR A DAY. MOISTEN IF DRY. PLACE TURF MATS ACROSS THE SLOPE IN STRAIGHT LINES, TIGHTLY BUTTED AND WITH JOINTS STAGGERED AND TO CORRECT LEVELS. CUT AROUND TREES, BUILDINGS AND BORDERS WITH A SHARP KNIFE. LIGHTLY ROLL AND DEEP WATER IMMEDIATELY AFTER LAYING. DEEP WATER LATE EVERY DAY FOR 3 WEEKS AND CONTINUE WEEKLY UNTIL THE END OF THE CONTRACT.

**SOWING GRASS**

REPLACE UNSATISFACTORY SOIL WITH 150MM LAYER OF TOPSOIL. ROTARY HOE IN TWO DIRECTIONS TO A DEPTH OF 150MM. RAKE TO A FINE TILTH, LEVEL AND SMOOTH WITH RUN-OFFS TO DRAINAGE OUTLETS. APPLY SELECTIVE HERBICIDE. SPREAD PRE-PLANT FERTILISER AT THE REQUIRED RATE FOR LAWN. SPREAD GRASS SEED AT HALF THE REQUIRED RATE IN EACH OF TWO DIRECTIONS AT RIGHT ANGLES, USING AN APPROVED SPREADER. LIGHTLY RAKE IN AND ROLL. WATER DEEPLY AND KEEP MOIST WITHOUT ANY RUN-OFF OF WATER UNTIL GERMINATION IS COMPLETE. CONTINUE WATERING AS NECESSARY UNTIL THE END OF THE CONTRACT. FIRST CUT ONLY WHEN GROWTH IS A MINIMUM OF 100MM AND ONLY DOWN TO 50MM.

**MAINTENANCE**

OWNER OF THE PROPERTY IS TO ENSURE THAT LANDSCAPING AREAS ARE MAINTAINED IN A MANNER AND DURATION TO COMPLY WITH COUNCIL REQUIREMENTS.

MAINTENANCE INCLUDES ANY OPERATIONS NECESSARY TO ASSURE GOOD PLANT GROWTH AND ATTAIN A TIDY WEED FREE APPEARANCE, INCLUDING BUT NOT LIMITED TO: REGULAR WATERING AS NECESSARY, WEEDING, CULTIVATING, PRUNING, CONTROLLING OF INSECTS, FUNGAL AND OTHER DISEASES.

REPAIR BROKEN STAKES AND TIES AND REPLACE TREES, SHRUBS, PLANTS AND AREAS OF LAWN THAT DIE TO THE SAME STANDARD AS DESCRIBED IN THIS SPECIFICATION.



**47 PINE AVE  
UPPER HUTT**

**NOTES:** - READ IN CONJUNCTION WITH THE SUBDIVISION AND ARCHITECTURAL DRAWINGS. - REFER ARCHITECTURAL PLANS FOR SITE DRAINAGE. - LANDSCAPE PLAN IS INDICATIVE. ALLOW TO CONFIRM LANDSCAPE POST BUILDING CONSTRUCTION.

- FLOOR PLANS AND SITE PLANS INCLUDING BOUNDARIES FROM ARCHITECT/ SURVEYOR. WE DO NOT TAKE LIABILITY FOR ITS ACCURACY. VERIFY SITE FEATURES ON SITE BEFORE CONSTRUCTION COMMENCES.

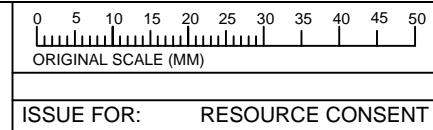

REV: AA DATE: 24/03/20 ISSUE: RESOURCE CONSENT  
 REV: B DATE: 31/03/20 ISSUE: RESOURCE CONSENT  
 REV: C DATE: 02/04/20 ISSUE: RESOURCE CONSENT

DOCUMENTS TO BE READ IN CONJUNCTION WITH DESIGNERS AND SURVEYORS DOCUMENTATION

**SPECIFICATION**

**PRINT IN COLOUR**

**L1.05**